

Reducing Insert MSS SP 79



This mss sp-79 standard Practice covers ratings, tolerances, finish, dimensions, marking and material requirements for socket-welding reducer inserts for use with ASME B16.11, Class 3000 and Class 6000 socket-welding fittings. customary unit dimensions for these reducer inserts are shown in Table 3 and SI (metric) dimensions are shown in Table 3M.

MSS SP-79 - Socket Welding Reducer Inserts

[Check ASME B16.11, Class 3000 and Class 6000 Reducing Insert MSS SP 79.](#)

Fitting Sizes/ Pipe Correlation Fittings covered by this Standard Practice are shown in Table 1, by class, size range and correlation to the schedule number or wall designation of pipe for calculation of ratings.

[Norma MSS SP 79](#)

SOCKET WELD FITTINGS REDUCER INSERTS · MSS-SP-79

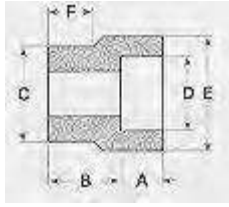

Type 1

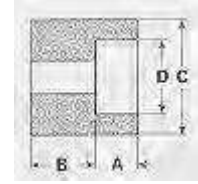

Type 2

Class 3000 - Schedule 40 BORE

FOR USE WITH SCHEDULE 40 OR 80 PIPE

Pipe Size	Type	A	B	C	D	E	F
1/2 x 3/8	1	7/16	13/16	.840	.695	1 1/16	5/8
1/2 x 1/4	1	3/8	13/16	.840	.560	7/8	5/8
1/2 x 1/8	1	3/8	13/16	.840	.425	7/8	11/16
3/4 x 1/2	1	1/2	7/8	1.050	.860	1 1/4	11/16
3/4 x 3/8	2	7/16	5/8	1.050	.695	---	---
3/4 x 1/4	2	3/8	11/16	1.050	.560	---	---
3/4 x 1/8	2	3/8	11/16	1.050	.425	---	---
1 x 3/4	1	9/16	15/16	1.313	1.070	1 1/2	3/4
1 x 1/2	2	1/2	5/8	1.313	.860	---	---
1 x 3/8	2	7/16	11/16	1.313	.695	---	---
1 x 1/4	2	3/8	3/4	1.313	.560	---	---
1 1/4 x 1	1	9/16	1	1.665	1.335	1 7/8	13/16
1 1/4 x 3/4	1	9/16	11/16	1.665	1.070	1 3/4	13/16
1 1/4 x 1/2	1	7/16	3/4	1.665	.860	1 3/4	13/16
1 1/2 x 1 1/4	1	1/2	1 1/8	1.900	1.680	2 3/16	7/8
1 1/2 x 1	1	1/2	11/16	1.900	1.335	2	7/8
1 1/2 x 3/4	1	1/2	3/4	1.900	1.070	2	7/8
1 1/2 x 1/2	1	3/8	13/16	1.900	.860	2	7/8
2 x 1 1/2	1	1/2	1 1/4	2.375	1.920	2 1/2	1
2 x 1 1/4	1	1/2	13/16	2.375	1.680	2 1/2	1
2 x 1	1	1/2	7/8	2.375	1.335	2 1/2	1
2 x 3/4	1	1/2	15/16	2.375	1.070	2 1/2	1
2 x 1/2	1	3/8	1	2.375	.860	2 1/2	1

Class 6000 - Schedule 160 BORE

FOR USE WITH SCHEDULE 160 PIPE

Pipe Size	Type	A	B	C	D	E	F
1/2 x 3/8	1	7/16	13/16	.840	.695	1 1/8	5/8
1/2 x 1/4	1	3/8	13/16	.840	.560	1	5/8
1/2 x 1/8	1	3/8	13/16	.840	.425	7/8	11/16
3/4 x 1/2	1	1/2	1	1.050	.860	1 3/8	3/4

3/4 x 3/8	2	7/16	5/8	1.050	.695	---	---
3/4 x 1/4	2	3/8	7/8	1.050	.560	---	---
3/4 x 1/8	2	3/8	11/16	1.050	.425	---	---
1 x 3/4	1	9/16	1 1/8	1.313	1.070	1 3/4	13/16
1 x 1/2	1	1/2	1 1/8	1.313	.860	1 3/8	13/16
1 x 3/8	2	7/16	7/8	1.313	.695	---	---
1 x 1/4	2	3/8	15/16	1.313	.560	---	---
1 1/4 x 1	1	5/8	1 3/16	1.665	1.335	2	7/8
1 1/4 x 3/4	2	9/16	13/16	1.665	1.070	1 3/4	7/8
1 1/4 x 1/2	2	1/2	7/8	1.665	.860	1 3/4	7/8
1 1/2 x 1 1/4	1	11/16	1 3/8	1.900	1.680	2 1/2	1
1 1/2 x 1	1	5/8	1 1/16	1.900	1.335	2	1
1 1/2 x 3/4	2	9/16	1	1.900	1.070	2	1
1 1/2 x 1/2	2	1/2	1 1/16	1.900	.860	2	1
2 x 1 1/2	1	3/4	11/16	2.375	1.920	2 3/4	1 1/8
2 x 1 1/4	2	11/16	15/16	2.375	1.680	---	---
2 x 1	2	5/8	1	2.375	1.335	---	---
2 x 3/4	2	9/16	1 1/16	2.375	1.070	---	---
2 x 1/2	2	1/2	1	2.375	.860	---	---

Also manufactured in sizes 4" x 3".